

KING ABDULLAH FINANCIAL DISTRICT – PARCEL 2.05

PEAK PERFORMANCE

Located within the 1.6 M sm King Abdullah Financial District, Parcel 2.05 takes an integrated approach to sustainability by minimizing the impact of the harsh desert environment in order to provide comfortable indoor and outdoor spaces. From strategic building orientation to a high performance building envelope with each façade customized according to solar exposure, Callison’s design minimizes energy consumption while providing optimal comfort for residents, office workers and visitors. A continuous ribbon of copper cladding wraps the office and residential buildings, providing filtered light for the spaces below and shading for exterior common areas. Outdoor gathering spaces feature drought tolerant native landscaping, creating an extension of the local environment. The District is currently under construction and all parcels are seeking LEED certification.

CLIENT

Rayadah Investment Company

LOCATION

Riyadh, Saudi Arabia

CLIMATE

Desert

SPECIFICATIONS

Tower: 65 Floors; 263.5m

Structural Grid: 11.00m x 13.00m

Retail: 5 Floors

Total GBA: 251,290m²

Site: 5,666m²

SUSTAINABLE DESIGN STRATEGIES

Window to wall ratio

Optimized daylight

High performance façade

Exterior solar shading

Operable exterior louvres

Drought tolerant landscaping

Each façade optimized

for solar performance

Shaded outdoor spaces



The landscape and perforated copper façade provide shading for comfortable exterior space. Each façade is optimized according to solar orientation.

TYPICAL OFFICE FLOOR PLAN

The shallow floor plan allows for optimal daylight to penetrate into the office space.

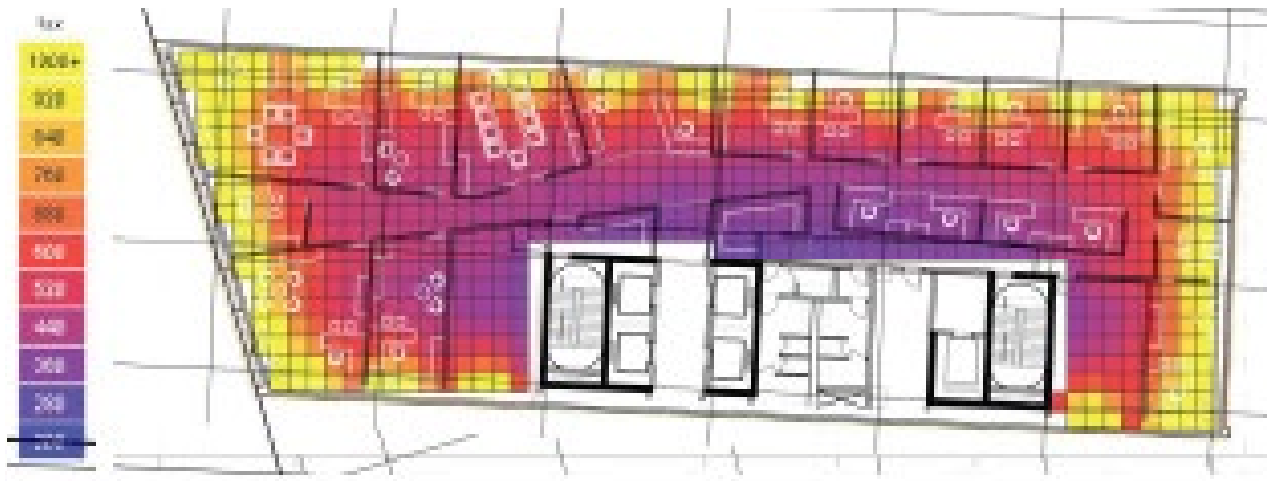

SHADING ANALYSIS

The office tower design utilizes self-shading through canted building forms and integration of external vertical fins. Canting the curtainwall at each level provides a horizontal shelf to shade the vision glazing below. Vertical fins are used to shade the low angle sun in the winter.

SUN ANGLE 75° AT 1:00 PM

